



Direct Trade (Yorkshire) Ltd Unit 3 Sandall Carr Industrial Estate, Sandall Carr Road, Kirk Sandall, Doncaster, DN3 1QL.  
Tel: 01302 880066 Fax: 01302 887070 Email: aluminium@directtradeltd.co.uk

## AluK BSF70 HI Bifold Doors

Quote ☐ Order ☐ Date \_\_\_\_\_

Job Reference / Number \_\_\_\_\_ ☐ Collection ☐ Delivery Date Required: \_\_\_\_\_

Company Name \_\_\_\_\_ Delivery Address: \_\_\_\_\_

Address \_\_\_\_\_

Postcode \_\_\_\_\_

Postcode \_\_\_\_\_ Telephone: \_\_\_\_\_ Fax: \_\_\_\_\_

Sign: \_\_\_\_\_ Print: \_\_\_\_\_ Order Taken by: \_\_\_\_\_

Overall Width (mm) \_\_\_\_\_ Overall Height (mm) \_\_\_\_\_ Open in ☐ Open Out ☐

***\*Including any Cills or Frame Extenders all viewed from the Outside***

***Size Limitations: Each panel must be no larger than 1200mm wide & 100kg in weight, no smaller than 550mm with a Maximum height of up to 3000mm, subject to wind load deflection (No calculations made unless specified)***

54 mm Fully Rebated Threshold ☐ 34mm Non-Weather Rated Threshold ☐ 22mm Room Divider ☐

Configuration: Number of Doors Number of Doors If Master Door is Req'd please  
Total Number of Sashes Folding / Sliding to the Left Folding / Sliding to the Right Indicate L / R

☐
☐
☐
☐ L

☐ R

### Standard Single Colour Options:

RAL 9005 Black Matt ☐

RAL 7016 Anthracite Grey Matt ☐

RAL 9910 White High Gloss ☐

### Standard Dual Colour Options:

RAL 7016 Anthracite Grey Matt / RAL 9910 White High Gloss ☐

\*RAL Inside: \_\_\_\_\_ / Colour: \_\_\_\_\_ High Gloss ☐ Semi-Gloss ☐ Matt ☐

\*RAL Outside \_\_\_\_\_ / Colour: \_\_\_\_\_ High Gloss ☐ Semi-Gloss ☐ Matt ☐

Marine Guarantee Required Please Tick ☐ \*For Marine environment applications please refer to disclaimer at the foot of page

***The above will incur an additional colour set-up cost and extended lead times***

Traffic Door Handle Black ☐ White ☐ Satin Silver ☐ Chrome ☐

Non-Locking T Handle Black ☐ White ☐ Satin Silver ☐ Chrome ☐

Locking T Handle \*(only on configurations without a traffic door) Black ☐ White ☐ Satin Silver ☐ Chrome ☐

### Hinges and Associated Hardware to be Black Finish as Standard

Drainage: Concealed ☐ Face ☐ None ☐ Cill: 95mm ☐ 150mm ☐ 177mm ☐ 190mm ☐ No Cill ☐

Overall Cill Size \_\_\_\_\_ mm (Cut To Size As Standard)

28mm QuickClip Square Bead (Pre Gasket) - Glazed Yes ☐ No ☐ (4/20/4 Clr Optitherm Si + Tough / Optifloat Tough Black W/edge Spacer)  
Optional Wedge Gasket - Please specify if Required

36mm Chamfered Bead (Standard Wedge) - Glazed Yes ☐ No ☐ (4/12/4/12/4 Clr Tough/ Ecoplus Tough/ Ecoplus Tough Black W/edge Spacer)

20mm Extender 40mm Extender

Left / Right / Top ☐ Left / Right / Top ☐ Trickle Vent Qty \_\_\_\_\_ (4000m<sup>2</sup> trickle vents through 40mm to the head)

Additional Requirements:  
e.g. Pas 24/Document Q

### Please note:

- We cannot guarantee any product installed within 50 metres of the coast, source of pollution or 2 metres from a swimming pool against deterioration of profile or hardware. Any product fitted within 5000 metres of a hostile environment a recommended cleaning regime must be adhered to and recorded (please consult product guide) - Additional costs may be incurred, please advise on the environment if appropriate.
- All frames are non-load bearing.

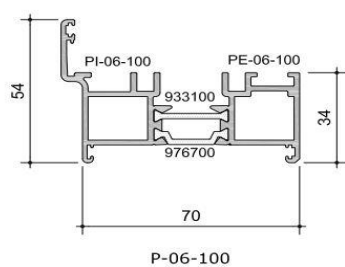

Rebated Threshold

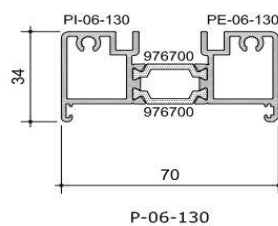

Non Weather Rated Low Threshold

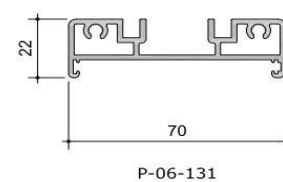

Non Thermally Broken Low Threshold



N60880 28mm Quickclip Square Bead

(Pre Gasket Standard / Optional Wedge Gasket)

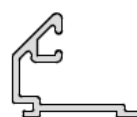

AW514 36mm Chamfered Bead

(Standard Wedge)

**For General Configurations Please (see below): Note: Types A, E, F, M & N will NOT have Lever / Lever or Master Door**

**Slave Door to have Finger Bolts as Standard**

### Configuration options

All style numbers shown below can be manufactured to open in the opposite direction. For example, style 3-2-1 can be reverse handed to 3-1-2.

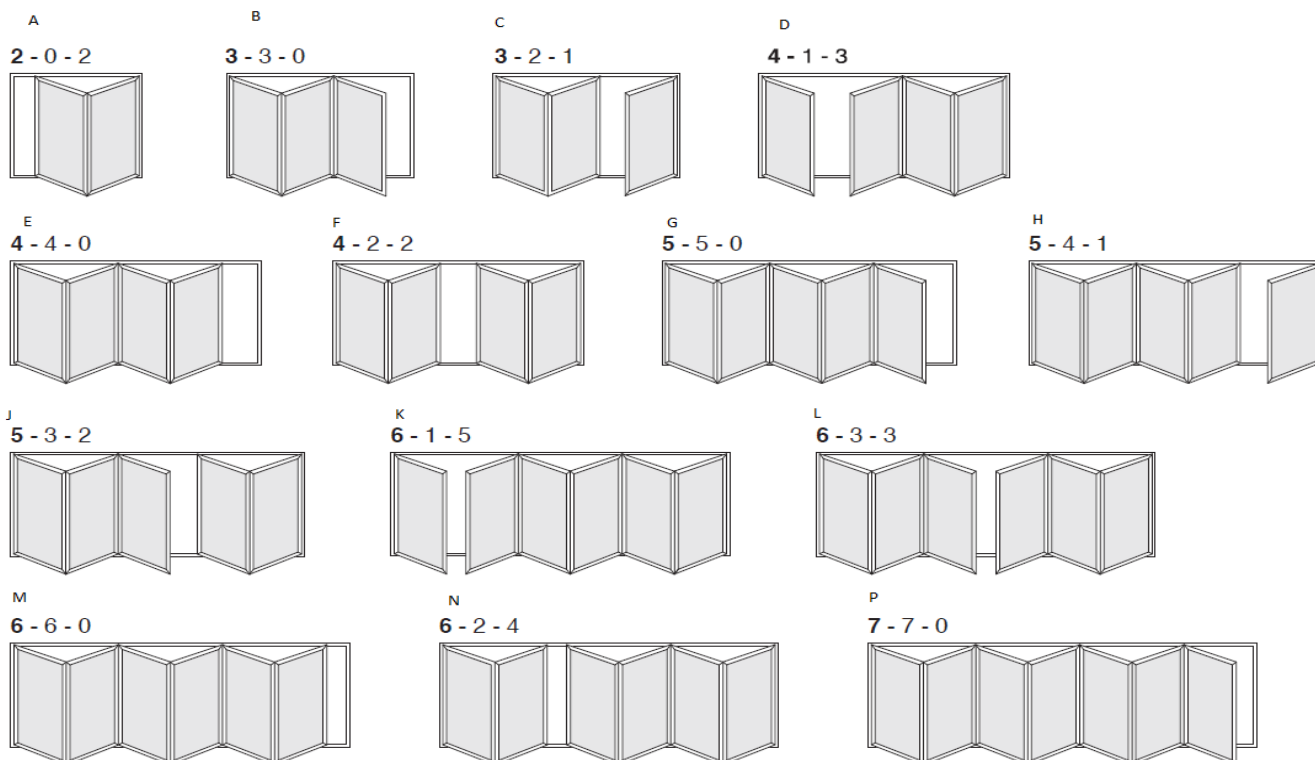

### Please note:

- We cannot guarantee any product installed within 50 metres of the coast, source of pollution or 2 metres from a swimming pool against deterioration of profile or hardware. Any product fitted within 5000 metres of a hostile environment a recommended cleaning regime must be adhered to and recorded (please consult product guide) - Additional costs may be incurred, please advise on the environment if appropriate.
- All frames are non-load bearing.

